

Polymax AV Mounts – B Type

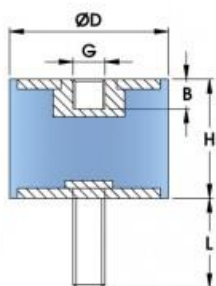

MALE - FEMALE Cylindrical mounts, a simple and cost effective mount. For use in compression and shear. A very large range of available size and studs.

H = Height
D = Diameter
G = Tread Size
L = Stud Length
B = Thread Depth

45 Shore Hardness (Max KG)		60 Shore Hardness (Max KG)	
-------------------------------	--	----------------------------------	--

Item Number	Description	D	H	G x L/B	Load	Sheer	Load	Sheer
B0607M3	Cyl. Mount (M/F) 6x7mm M3 x 6/M3	6	7	M3x6/M3	1.43	0.4	2.42	0.7
B0806M3	Cyl. Mount (M/F) 8x6mm M3 x 6/M3	8	6	M3x6/M3	3.025	0.9	5.335	1.6
B0808M3	Cyl. Mount (M/F) 8x8mm M3 x 6/M3	8	8	M3x6/M3	2.64	0.8	4.84	1.5
B0810M3	Cyl. Mount (M/F) 8x10mm M3 x 6/M3	8	10	M3x6/M3	2.2	0.8	4.4	1.4
B0912M3	Cyl. Mount (M/F) 9x12mm M3 x 6/M3	9	12	M3x6/M3	1.98	0.6	5.94	1.62
B0912M4	Cyl. Mount (M/F) 9x12mm M4 x 10/M4	9	12	M4x10/M4	1.98	0.6	5.94	1.62
B1008M3	Cyl. Mount (M/F) 10x8mm M3 x 6/M3	10	8	M3x6/M3	2.97	0.9	8.69	2.4
B1008M4	Cyl. Mount (M/F) 10x8mm M4 x 10/M4	10	8	M4x10/M4	2.97	0.9	8.69	2.4
B1010M4	Cyl. Mount (M/F) 10x10mm M4 x 10/M4	10	10	M4x10/M4	2.75	1	8.47	3.1
B1015M3	Cyl. Mount (M/F) 10x15mm M3 x 6/M3	10	15	M3x6/M3	1.98	0.7	6.16	2.3
B1017M4	Cyl. Mount (M/F) 10x17mm M4 x 10/M4	10	17	M4x10/M4	1.76	0.5	5.5	1.6
B1018M5	Cyl. Mount (M/F) 10x18mm M5 x 12/M5	10	18	M5x12/M5	1.54	0.45	4.95	1.5
B1111M3	Cyl. Mount (M/F) 11x11mm M3 x 6/M3	11	11	M3x6/M3	2.2	0.8	6.27	2.3
B1111M4	Cyl. Mount (M/F) 11x11mm M4 x 10/M4	11	11	M4x10/M4	2.2	0.8	6.27	2.3
B1210M3	Cyl. Mount (M/F) 12x10mm M3 x 6/M3	12	10	M3x6/M3	3.85	1.4	11	3
B1210M4	Cyl. Mount (M/F) 12x10mm M4 x 10/M4	12	10	M4x10/M4	3.85	1.4	11	3
B1326M3	Cyl. Mount (M/F) 13x26mm M3 x 6/M3	13	26	M3x6/M3	1.54	0.45	4.95	1.5
B1326M4	Cyl. Mount (M/F) 13x26mm M4 x 10/M4	13	26	M4x10/M4	1.54	0.45	4.95	1.5
B1326M5	Cyl. Mount (M/F) 13x26mm M5 x 12/M5	13	26	M5x12/M5	1.54	0.45	4.95	1.5
B1508M4	Cyl. Mount (M/F) 15x8mm M4 x 10/M4	15	8	M4x10/M4	13.2	3	27.5	5.2
B1510M4	Cyl. Mount (M/F) 15x10mm M4 x 10/M4	15	10	M4x10/M4	10.12	4	16.61	5.2
B1510M5	Cyl. Mount (M/F) 15x10mm M5 x 12/M5	15	10	M5x12/M5	10.12	4	16.61	5.2
B1512M4	Cyl. Mount (M/F) 15x12mm M4 x 10/M4	15	12	M4x10/M4	9.02	2.7	15.95	5.2
B1512M5	Cyl. Mount (M/F) 15x12mm M5 x 12/M5	15	12	M5x12/M5	9.02	2.7	15.95	5.2
B1513M4	Cyl. Mount (M/F) 15x13mm M4 x 10/M4	15	13	M4x10/M4	8.69	2.6	15.51	5.2
B1513M5	Cyl. Mount (M/F) 15x13mm M5 x 12/M5	15	13	M5x12/M5	8.69	2.6	15.51	5.2
B1515M4	Cyl. Mount (M/F) 15x15mm M4 x 10/M4	15	15	M4x10/M4	6.6	2	14.63	5.2

This information is for customer guidance only. Polymax reserves the right to amend specification without prejudice.

Polymax Ltd, Building 90, SEME, Budds Lane, Bordon, Hampshire, GU35 0JE
Email: sales@polymax.co.uk Phone: +44 (0) 1420 474123 Fax: +44 (0) 1420 487816

B1515M5	Cyl. Mount (M/F) 15x15mm M5 x 12/M5	15	15	M5x12/M5	6.6	2	14.63	5.2
B1520M4	Cyl. Mount (M/F) 15x20mm M4 x 10/M4	15	20	M4x10/M4	5.39	1.6	11	4
B1520M5	Cyl. Mount (M/F) 15x20mm M5 x 12/M5	15	20	M5x12/M5	5.39	1.6	11	4
B1525M4	Cyl. Mount (M/F) 15x25mm M4 x 10/M4	15	25	M4x10/M4	3.19	1	7.975	2.4
B1525M5	Cyl. Mount (M/F) 15x25mm M5 x 12/M5	15	25	M5x12/M5	3.19	1	7.975	2.4
B1530M4	Cyl. Mount (M/F) 15x30mm M4 x 10/M4	15	30	M4x10/M4	1.925	0.6	4.51	1.4
B1530M5	Cyl. Mount (M/F) 15x30mm M5 x 12/M5	15	30	M5x12/M5	1.925	0.6	4.51	1.4
B1610M4	Cyl. Mount (M/F) 16x10mm M4 x 10/M4	16	10	M4x10/M4	16.5	6	0	0
B1610M5	Cyl. Mount (M/F) 16x10mm M5 x 12/M5	16	10	M5x12/M5	16.5	6	0	0
B1618M4	Cyl. Mount (M/F) 16x18mm M4 x 10/M4	16	18	M4x10/M4	6.6	2	14.63	5.2
B1618M5	Cyl. Mount (M/F) 16x18mm M5 x 15/M5	16	18	M5x15/M5	6.6	2	14.63	5.2
B2010M5	Cyl. Mount (M/F) 20x10mm M5 x 15/M5	20	10	M5x15/M5	18.7	6.8	35.64	9.2
B2010M6	Cyl. Mount (M/F) 20x10mm M6 x 20/M6	20	10	M6x20/M6	18.7	6.8	35.64	9.2
B2011M5	Cyl. Mount (M/F) 20x11mm M5 x 15/M5	20	11	M5x15/M5	18.7	6.5	30.91	9.2
B2011M6	Cyl. Mount (M/F) 20x11mm M6 x 20/M6	20	11	M6x20/M6	18.7	6.5	30.91	9.2
B2012M5	Cyl. Mount (M/F) 20x12mm M5 x 15/M5	20	12	M5x15/M5	16.28	5.9	30.91	9.2
B2012M6	Cyl. Mount (M/F) 20x12mm M6 x 20/M6	20	12	M6x20/M6	16.28	5.9	30.91	9.2
B2015M5	Cyl. Mount (M/F) 20x15mm M5 x 15/M5	20	15	M5x15/M5	13.53	4.2	28.05	9.2
B2015M6	Cyl. Mount (M/F) 20x15mm M6 x 20/M6	20	15	M6x20/M6	13.53	4.2	28.05	9.2
B2017M5	Cyl. Mount (M/F) 20x17mm M5 x 15/M5	20	17	M5x15/M5	12.98	4.2	27.06	9.2
B2017M6	Cyl. Mount (M/F) 20x17mm M6 x 20/M6	20	17	M6x20/M6	12.98	4.2	27.06	9.2
B2017M8	Cyl. Mount (M/F) 20x17mm M8 x 20/M8	20	17	M8x20/M8	12.98	4.2	27.06	9.2
B2020M5	Cyl. Mount (M/F) 20x20mm M5 x 15/M5	20	20	M5x15/M5	12.1	4.2	25.85	9.2
B2020M6	Cyl. Mount (M/F) 20x20mm M6 x 20/M6	20	20	M6x20/M6	12.1	4.2	25.85	9.2
B2020M8	Cyl. Mount (M/F) 20x20mm M8 x 20/M8	20	20	M8x20/M8	12.1	4.2	25.85	9.2
B2025M5	Cyl. Mount (M/F) 20x25mm M5 x 15/M5	20	25	M5x15/M5	11.55	4.2	24.97	9.2
B2025M6	Cyl. Mount (M/F) 20x25mm M6 x 20/M6	20	25	M6x20/M6	11.55	4.2	24.97	9.2
B2025M8	Cyl. Mount (M/F) 20x25mm M8 x 20/M8	20	25	M8x20/M8	11.55	4.2	24.97	9.2
B2030M5	Cyl. Mount (M/F) 20x30mm M5 x 15/M5	20	30	M5x15/M5	11.22	4.1	24.53	9
B2030M6	Cyl. Mount (M/F) 20x30mm M6 x 20/M6	20	30	M6x20/M6	11.22	4.1	24.53	9
B2030M8	Cyl. Mount (M/F) 20x30mm M8 x 20/M8	20	30	M8x20/M8	11.22	4.1	24.53	9
B2515M6	Cyl. Mount (M/F) 25x15mm M6 x 20/M6	25	15	M6x20/M6	23.65	6.6	47.52	14.4
B2515M8	Cyl. Mount (M/F) 25x15mm M8 x 20/M8	25	15	M8x20/M8	23.65	6.6	47.52	14.4
B2517M6	Cyl. Mount (M/F) 25x17mm M6 x 20/M6	25	17	M6x20/M6	22.77	6.6	46.31	14.4
B2517M8	Cyl. Mount (M/F) 25x17mm M8 x 20/M8	25	17	M8x20/M8	22.77	6.6	46.31	14.4
B2520M6	Cyl. Mount (M/F) 25x20mm M6 x 20/M6	25	20	M6x20/M6	20.24	6.6	42.35	14.4
B2520M8	Cyl. Mount (M/F) 25x20mm M8 x 20/M8	25	20	M8x20/M8	20.24	6.6	42.35	14.4
B2522M6	Cyl. Mount (M/F) 25x22mm M6 x 20/M6	25	22	M6x20/M6	19.58	6.6	41.14	14.4
B2522M8	Cyl. Mount (M/F) 25x22mm M8 x 20/M8	25	22	M8x20/M8	19.58	6.6	41.14	14.4
B2525M6	Cyl. Mount (M/F) 25x25mm M6 x 20/M6	25	25	M6x20/M6	18.81	6.6	40.26	14.4
B2525M8	Cyl. Mount (M/F) 25x25mm M8 x 20/M8	25	25	M8x20/M8	18.81	6.6	40.26	14.4

This information is for customer guidance only. Polymax reserves the right to amend specification without prejudice.

Polymax Ltd, Building 90, SEME, Budds Lane, Bordon, Hampshire, GU35 0JE

Email: sales@polymax.co.uk Phone: +44 (0) 1420 474123 Fax: +44 (0) 1420 487816

B2527M6	Cyl. Mount (M/F) 25x27mm M6 x 20/M6	25	27	M6x20/M6	18.48	6.6	39.82	14.4
B2527M8	Cyl. Mount (M/F) 25x27mm M8 x 20/M8	25	27	M8x20/M8	18.48	6.6	39.82	14.4
B2528M6	Cyl. Mount (M/F) 25x28mm M6 x 20/M6	25	28	M6x20/M6	17.82	6.6	39.49	14.4
B2528M8	Cyl. Mount (M/F) 25x28mm M8 x 20/M8	25	28	M8x20/M8	17.82	6.6	39.49	14.4
B2530M6	Cyl. Mount (M/F) 25x30mm M6 x 20/M6	25	30	M6x20/M6	18.04	6.6	39.16	14.4
B2530M8	Cyl. Mount (M/F) 25x30mm M8 x 20/M8	25	30	M8x20/M8	18.04	6.6	39.16	14.4
B2622M6	Cyl. Mount (M/F) 26x22mm M6 x 20/M6	26	22	M6x20/M6	20.35	7.5	42.9	16.8
B2622M8	Cyl. Mount (M/F) 26x22mm M8 x 20/M8	26	22	M8x20/M8	20.35	7.5	42.9	16.8
B3015M10	Cyl. Mount (M/F) 30x15mm M10x25/M10	30	15	M10x25/M10	41.58	9.5	79.53	20.8
B3015M6	Cyl. Mount (M/F) 30x15mm M6 x 20/M6	30	15	M6x20/M6	41.58	9.5	79.53	20.8
B3015M8	Cyl. Mount (M/F) 30x15mm M8 x 20/M8	30	15	M8x20/M8	41.58	9.5	79.53	20.8
B3017M10	Cyl. Mount (M/F) 30x17mm M10x25/M10	30	17	M10x25/M10	39.6	9.5	73.7	20.8
B3017M6	Cyl. Mount (M/F) 30x17mm M6 x 20/M6	30	17	M6x20/M6	39.6	9.5	73.7	20.8
B3017M8	Cyl. Mount (M/F) 30x17mm M8 x 20/M8	30	17	M8x20/M8	39.6	9.5	73.7	20.8
B3018M10	Cyl. Mount (M/F) 30x18mm M10x25/M10	30	18	M10x25/M10	37.4	9.5	69.3	20.8
B3018M6	Cyl. Mount (M/F) 30x18mm M6 x 20/M6	30	18	M6x20/M6	37.4	9.5	69.3	20.8
B3018M8	Cyl. Mount (M/F) 30x18mm M8 x 20/M8	30	18	M8x20/M8	37.4	9.5	69.3	20.8
B3020M10	Cyl. Mount (M/F) 30x20mm M10x25/M10	30	20	M10x25/M10	32.45	9.5	66	20.8
B3020M6	Cyl. Mount (M/F) 30x20mm M6 x 20/M6	30	20	M6x20/M6	32.45	9.5	66	20.8
B3020M8	Cyl. Mount (M/F) 30x20mm M8 x 20/M8	30	20	M8x20/M8	32.45	9.5	66	20.8
B3022M10	Cyl. Mount (M/F) 30x22mm M10x25/M10	30	22	M10x25/M10	29.7	9.5	62.7	20.8
B3022M6	Cyl. Mount (M/F) 30x22mm M6 x 20/M6	30	22	M6x20/M6	29.7	9.5	62.7	20.8
B3022M8	Cyl. Mount (M/F) 30x22mm M8 x 20/M8	30	22	M8x20/M8	29.7	9.5	62.7	20.8
B3025M10	Cyl. Mount (M/F) 30x25mm M10x25/M10	30	25	M10x25/M10	28.93	9.5	60.72	20.8
B3025M6	Cyl. Mount (M/F) 30x25mm M6 x 20/M6	30	25	M6x20/M6	28.93	9.5	60.72	20.8
B3025M8	Cyl. Mount (M/F) 30x25mm M8 x 20/M8	30	25	M8x20/M8	28.93	9.5	60.72	20.8
B3030M10	Cyl. Mount (M/F) 30x30mm M10x25/M10	30	30	M10x25/M10	27.28	9.5	58.19	20.8
B3030M6	Cyl. Mount (M/F) 30x30mm M6 x 20/M6	30	30	M6x20/M6	27.28	9.5	58.19	20.8
B3030M8	Cyl. Mount (M/F) 30x30mm M8 x 20/M8	30	30	M8x20/M8	27.28	9.5	58.19	20.8
B3035M10	Cyl. Mount (M/F) 30x35mm M10x25/M10	30	35	M10x25/M10	26.4	9.5	56.1	20.8
B3035M6	Cyl. Mount (M/F) 30x35mm M6 x 20/M6	30	35	M6x20/M6	26.4	9.5	56.1	20.8
B3035M8	Cyl. Mount (M/F) 30x35mm M8 x 20/M8	30	35	M8x20/M8	26.4	9.5	56.1	20.8
B3040M10	Cyl. Mount (M/F) 30x40mm M10x25/M10	30	40	M10x25/M10	25.63	9.5	55.88	20.8
B3040M6	Cyl. Mount (M/F) 30x40mm M6 x 20/M6	30	40	M6x20/M6	25.63	9.5	55.88	20.8
B3040M8	Cyl. Mount (M/F) 30x40mm M8 x 20/M8	30	40	M8x20/M8	25.63	9.5	55.88	20.8
B3045M10	Cyl. Mount (M/F) 30x45mm M10x25/M10	30	45	M10x25/M10	22	9.5	44	20.8
B3045M6	Cyl. Mount (M/F) 30x45mm M6 x 20/M6	30	45	M6x20/M6	22	9.5	44	20.8
B3045M8	Cyl. Mount (M/F) 30x45mm M8 x 20/M8	30	45	M8x20/M8	22	9.5	44	20.8
B3535M8	Cyl. Mount (M/F) 35x35mm M8 x 20/M8	35	35	M8x20/M8	56.1	24	69.3	33
B4015M10	Cyl. Mount (M/F) 40x15mm M10x25/M10	40	15	M10x25/M10	33	8	55	12
B4015M6	Cyl. Mount (M/F) 40x15mm M6 x 20/M6	40	15	M6x20/M6	33	8	55	12

This information is for customer guidance only. Polymax reserves the right to amend specification without prejudice.

Polymax Ltd, Building 90, SEME, Budds Lane, Bordon, Hampshire, GU35 0JE

Email: sales@polymax.co.uk Phone: +44 (0) 1420 474123 Fax: +44 (0) 1420 487816

B4015M8	Cyl. Mount (M/F) 40x15mm M8 x 23/M8	40	15	M8x23/M8	33	8	55	12
B4020M10	Cyl. Mount (M/F) 40x20mm M10x25/M10	40	20	M10x25/M10	69.52	17	134.86	36.9
B4020M6	Cyl. Mount (M/F) 40x20mm M6 x 20/M6	40	20	M6x20/M6	69.52	17	134.86	36.9
B4020M8	Cyl. Mount (M/F) 40x20mm M8 x 23/M8	40	20	M8x23/M8	69.52	17	134.86	36.9
B4025M10	Cyl. Mount (M/F) 40x25mm M10x25/M10	40	25	M10x25/M10	59.4	17	123.2	36.9
B4025M6	Cyl. Mount (M/F) 40x25mm M6 x 20/M6	40	25	M6x20/M6	59.4	17	123.2	36.9
B4025M8	Cyl. Mount (M/F) 40x25mm M8 x 23/M8	40	25	M8x23/M8	59.4	17	123.2	36.9
B4028M10	Cyl. Mount (M/F) 40x28mm M10x25/M10	40	28	M10x25/M10	54.12	17	114.4	36.9
B4028M6	Cyl. Mount (M/F) 40x28mm M6 x 20/M6	40	28	M6x20/M6	54.12	17	114.4	36.9
B4028M8	Cyl. Mount (M/F) 40x28mm M8 x 23/M8	40	28	M8x23/M8	54.12	17	114.4	36.9
B4030M10	Cyl. Mount (M/F) 40x30mm M10x25/M10	40	30	M10x25/M10	52.91	17	110.22	36.9
B4030M6	Cyl. Mount (M/F) 40x30mm M6 x 20/M6	40	30	M6x20/M6	52.91	17	110.22	36.9
B4030M8	Cyl. Mount (M/F) 40x30mm M8 x 23/M8	40	30	M8x23/M8	52.91	17	110.22	36.9
B4035M10	Cyl. Mount (M/F) 40x35mm M10x25/M10	40	35	M10x25/M10	50.6	17	107.58	36.9
B4035M6	Cyl. Mount (M/F) 40x35mm M6 x 20/M6	40	35	M6x20/M6	50.6	17	107.58	36.9
B4035M8	Cyl. Mount (M/F) 40x35mm M8 x 23/M8	40	35	M8x23/M8	50.6	17	107.58	36.9
B4038M10	Cyl. Mount (M/F) 40x38mm M10x25/M10	40	38	M10x25/M10	48.95	17	105.16	36.9
B4038M6	Cyl. Mount (M/F) 40x38mm M6 x 20/M6	40	38	M6x20/M6	48.95	17	105.16	36.9
B4038M8	Cyl. Mount (M/F) 40x38mm M8 x 23/M8	40	38	M8x23/M8	48.95	17	105.16	36.9
B4040M10	Cyl. Mount (M/F) 40x40mm M10x25/M10	40	40	M10x25/M10	48.07	17	102.85	36.9
B4040M6	Cyl. Mount (M/F) 40x40mm M6 x 20/M6	40	40	M6x20/M6	48.07	17	102.85	36.9
B4040M8	Cyl. Mount (M/F) 40x40mm M8 x 23/M8	40	40	M8x23/M8	48.07	17	102.85	36.9
B4045M10	Cyl. Mount (M/F) 40x45mm M10x25/M10	40	45	M10x25/M10	46.31	15	86.13	32
B4045M6	Cyl. Mount (M/F) 40x45mm M6 x 20/M6	40	45	M6x20/M6	46.31	15	86.13	32
B4045M8	Cyl. Mount (M/F) 40x45mm M8 x 23/M8	40	45	M8x23/M8	46.31	15	86.13	32
B4060M10	Cyl. Mount (M/F) 40x60mm M10x25/M10	40	60	M10x25/M10	42.79	14	53.13	28.5
B4060M6	Cyl. Mount (M/F) 40x60mm M6 x 20/M6	40	60	M6x20/M6	42.79	14	53.13	28.5
B4060M8	Cyl. Mount (M/F) 40x60mm M8 x 23/M8	40	60	M8x23/M8	42.79	14	53.13	28.5
B5020M10	Cyl. Mount (M/F) 50x20mm M10x25/M10	50	20	M10x25/M10	137.28	26.5	253.66	57.7
B5020M12	Cyl. Mount (M/F) 50x20mm M12x33/M12	50	20	M12x33/M12	137.28	26.5	253.66	57.7
B5020M8	Cyl. Mount (M/F) 50x20mm M8 x 23/M8	50	20	M8x23/M8	137.28	26.5	253.66	57.7
B5021M10	Cyl. Mount (M/F) 50x21mm M10x25/M10	50	21	M10x25/M10	134.64	26.5	250.03	57.7
B5021M12	Cyl. Mount (M/F) 50x21mm M12x33/M12	50	21	M12x33/M12	134.64	26.5	250.03	57.7
B5021M8	Cyl. Mount (M/F) 50x21mm M8 x 23/M8	50	21	M8x23/M8	134.64	26.5	250.03	57.7
B5025M10	Cyl. Mount (M/F) 50x25mm M10x25/M10	50	25	M10x25/M10	107.36	26.5	209	57.7
B5025M12	Cyl. Mount (M/F) 50x25mm M12x33/M12	50	25	M12x33/M12	107.36	26.5	209	57.7
B5025M8	Cyl. Mount (M/F) 50x25mm M8 x 23/M8	50	25	M8x23/M8	107.36	26.5	209	57.7
B5028M10	Cyl. Mount (M/F) 50x28mm M10x25/M10	50	28	M10x25/M10	97.79	26.5	194.81	57.7
B5028M12	Cyl. Mount (M/F) 50x28mm M12x33/M12	50	28	M12x33/M12	97.79	26.5	194.81	57.7
B5028M8	Cyl. Mount (M/F) 50x28mm M8 x 23/M8	50	28	M8x23/M8	97.79	26.5	194.81	57.7
B5030M10	Cyl. Mount (M/F) 50x30mm M10x25/M10	50	30	M10x25/M10	93.06	26.5	187.66	57.7

This information is for customer guidance only. Polymax reserves the right to amend specification without prejudice.

Polymax Ltd, Building 90, SEME, Budds Lane, Bordon, Hampshire, GU35 0JE

Email: sales@polymax.co.uk Phone: +44 (0) 1420 474123 Fax: +44 (0) 1420 487816

B5030M12	Cyl. Mount (M/F) 50x30mm M12x33/M12	50	30	M12x33/M12	93.06	26.5	187.66	57.7
B5030M8	Cyl. Mount (M/F) 50x30mm M8 x 23/M8	50	30	M8x23/M8	93.06	26.5	187.66	57.7
B5035M10	Cyl. Mount (M/F) 50x35mm M10x25/M10	50	35	M10x25/M10	85.14	26.5	175.78	57.7
B5035M12	Cyl. Mount (M/F) 50x35mm M12x33/M12	50	35	M12x33/M12	85.14	26.5	175.78	57.7
B5035M8	Cyl. Mount (M/F) 50x35mm M8 x 23/M8	50	35	M8x23/M8	85.14	26.5	175.78	57.7
B5037M10	Cyl. Mount (M/F) 50x37mm M10x25/M10	50	37	M10x25/M10	81.4	26.5	171.6	57.7
B5037M12	Cyl. Mount (M/F) 50x37mm M12x33/M12	50	37	M12x33/M12	81.4	26.5	171.6	57.7
B5037M8	Cyl. Mount (M/F) 50x37mm M8 x 23/M8	50	37	M8x23/M8	81.4	26.5	171.6	57.7
B5040M10	Cyl. Mount (M/F) 50x40mm M10x25/M10	50	40	M10x25/M10	80.3	26.5	168.63	57.7
B5040M12	Cyl. Mount (M/F) 50x40mm M12x33/M12	50	40	M12x33/M12	80.3	26.5	168.63	57.7
B5040M8	Cyl. Mount (M/F) 50x40mm M8 x 23/M8	50	40	M8x23/M8	80.3	26.5	168.63	57.7
B5042M10	Cyl. Mount (M/F) 50x42mm M10x25/M10	50	42	M10x25/M10	78.65	26.5	166.21	57.7
B5042M12	Cyl. Mount (M/F) 50x42mm M12x33/M12	50	42	M12x33/M12	78.65	26.5	166.21	57.7
B5042M8	Cyl. Mount (M/F) 50x42mm M8 x 23/M8	50	42	M8x23/M8	78.65	26.5	166.21	57.7
B5045M10	Cyl. Mount (M/F) 50x45mm M10x25/M10	50	45	M10x25/M10	77.11	26.5	163.9	57.7
B5045M12	Cyl. Mount (M/F) 50x45mm M12x33/M12	50	45	M12x33/M12	77.11	26.5	163.9	57.7
B5045M8	Cyl. Mount (M/F) 50x45mm M8 x 23/M8	50	45	M8x23/M8	77.11	26.5	163.9	57.7
B5050M10	Cyl. Mount (M/F) 50x50mm M10x25/M10	50	50	M10x25/M10	74.91	26.5	160.6	57.7
B5050M12	Cyl. Mount (M/F) 50x50mm M12x33/M12	50	50	M12x33/M12	74.91	26.5	160.6	57.7
B5050M8	Cyl. Mount (M/F) 50x50mm M8 x 23/M8	50	50	M8x23/M8	74.91	26.5	160.6	57.7
B5080M10	Cyl. Mount (M/F) 50x80mm M10x25/M10	50	80	M10x25/M10	46.86	22	100.32	50
B5080M12	Cyl. Mount (M/F) 50x80mm M12x33/M12	50	80	M12x33/M12	46.86	22	100.32	50
B5080M8	Cyl. Mount (M/F) 50x80mm M8 x 23/M8	50	80	M8x23/M8	46.86	22	100.32	50
B6025M10	Cyl. Mount (M/F) 60x25mm M10x25/M10	60	25	M10x25/M10	167.75	30	312.18	68
B6025M8	Cyl. Mount (M/F) 60x25mm M8 x 23/M8	60	25	M8x23/M8	167.75	30	312.18	68
B6030M10	Cyl. Mount (M/F) 60x30mm M10x25/M10	60	30	M10x25/M10	142.56	30	264	68
B6030M12	Cyl. Mount (M/F) 60x30mm M12x37/M12	60	30	M12x37/M12	142.56	30	264	68
B6030M8	Cyl. Mount (M/F) 60x30mm M8 x 23/M8	60	30	M8x23/M8	142.56	30	264	68
B6035M10	Cyl. Mount (M/F) 60x35mm M10x25/M10	60	35	M10x25/M10	136.07	30	252.78	68
B6035M12	Cyl. Mount (M/F) 60x35mm M12x37/M12	60	35	M12x37/M12	136.07	30	252.78	68
B6035M8	Cyl. Mount (M/F) 60x35mm M8 x 23/M8	60	35	M8x23/M8	136.07	30	252.78	68
B6040M10	Cyl. Mount (M/F) 60x40mm M10x25/M10	60	40	M10x25/M10	123.2	30	230.01	68
B6040M12	Cyl. Mount (M/F) 60x40mm M12x37/M12	60	40	M12x37/M12	123.2	30	230.01	68
B6040M8	Cyl. Mount (M/F) 60x40mm M8 x 23/M8	60	40	M8x23/M8	123.2	30	230.01	68
B6045M10	Cyl. Mount (M/F) 60x45mm M10x25/M10	60	45	M10x25/M10	110.11	30	205.48	68
B6045M12	Cyl. Mount (M/F) 60x45mm M12x37/M12	60	45	M12x37/M12	110.11	30	205.48	68
B6045M8	Cyl. Mount (M/F) 60x45mm M8 x 23/M8	60	45	M8x23/M8	110.11	30	205.48	68
B6050M10	Cyl. Mount (M/F) 60x50mm M10x25/M10	60	50	M10x25/M10	97.79	30	182.05	68
B6050M12	Cyl. Mount (M/F) 60x50mm M12x37/M12	60	50	M12x37/M12	97.79	30	182.05	68
B6050M8	Cyl. Mount (M/F) 60x50mm M8 x 23/M8	60	50	M8x23/M8	97.79	30	182.05	68
B6060M10	Cyl. Mount (M/F) 60x60mm M10x25/M10	60	60	M10x25/M10	80.3	30	149.6	68

This information is for customer guidance only. Polymax reserves the right to amend specification without prejudice.

Polymax Ltd, Building 90, SEME, Budds Lane, Bordon, Hampshire, GU35 0JE

Email: sales@polymax.co.uk Phone: +44 (0) 1420 474123 Fax: +44 (0) 1420 487816

B6060M12	Cyl. Mount (M/F) 60x60mm M12x37/M12	60	60	M12x37/M12	80.3	30	149.6	68
B6060M8	Cyl. Mount (M/F) 60x60mm M8 x 23/M8	60	60	M8x23/M8	80.3	30	149.6	68
B6535M12	Cyl. Mount (M/F) 65x35mm M12x37/M12	65	35	M12x37/M12	176	35	385	68
B7030M10	Cyl. Mount (M/F) 70x30mm M10x25/M10	70	30	M10x25/M10	236.94	40	503.25	80
B7030M12	Cyl. Mount (M/F) 70x30mm M12x37/M12	70	30	M12x37/M12	236.94	40	503.25	80
B7035M10	Cyl. Mount (M/F) 70x35mm M10x25/M10	70	35	M10x25/M10	208.56	40	430.21	80
B7035M12	Cyl. Mount (M/F) 70x35mm M12x37/M12	70	35	M12x37/M12	208.56	40	430.21	80
B7040M10	Cyl. Mount (M/F) 70x40mm M10x25/M10	70	40	M10x25/M10	180.18	40	357.28	80
B7040M12	Cyl. Mount (M/F) 70x40mm M12x37/M12	70	40	M12x37/M12	180.18	40	357.28	80
B7045M10	Cyl. Mount (M/F) 70x45mm M10x25/M10	70	45	M10x25/M10	173.25	40	341.55	80
B7045M12	Cyl. Mount (M/F) 70x45mm M12x37/M12	70	45	M12x37/M12	173.25	40	341.55	80
B7050M10	Cyl. Mount (M/F) 70x50mm M10x25/M10	70	50	M10x25/M10	156.53	40	321.97	80
B7050M12	Cyl. Mount (M/F) 70x50mm M12x37/M12	70	50	M12x37/M12	156.53	40	321.97	80
B7055M10	Cyl. Mount (M/F) 70x55mm M10x25/M10	70	55	M10x25/M10	149.71	40	311.74	80
B7055M12	Cyl. Mount (M/F) 70x55mm M12x37/M12	70	55	M12x37/M12	149.71	40	311.74	80
B7060M10	Cyl. Mount (M/F) 70x60mm M10x25/M10	70	60	M10x25/M10	132	40	242	80
B7060M12	Cyl. Mount (M/F) 70x60mm M12x37/M12	70	60	M12x37/M12	132	40	242	80
B7070M10	Cyl. Mount (M/F) 70x70mm M10x25/M10	70	70	M10x25/M10	121	40	209	80
B7070M12	Cyl. Mount (M/F) 70x70mm M12x37/M12	70	70	M12x37/M12	121	40	209	80
B75100M10	Cyl. Mount (M/F) 75x100mm M10x30/M10	75	0	M10x30/M10	137.83	40.7	291.5	105.3
B75100M12	Cyl. Mount (M/F) 75x100mm M12x37/M12	75	0	M12x37/M12	137.83	40.7	291.5	105.3
B7525M10	Cyl. Mount (M/F) 75x25mm M10x30/M10	75	25	M10x30/M10	329.34	59.6	715	129.9
B7525M12	Cyl. Mount (M/F) 75x25mm M12x37/M12	75	25	M12x37/M12	329.34	59.6	715	129.9
B7530M10	Cyl. Mount (M/F) 75x30mm M10x30/M10	75	30	M10x30/M10	294.03	59.6	624.47	129.9
B7530M12	Cyl. Mount (M/F) 75x30mm M12x37/M12	75	30	M12x37/M12	294.03	59.6	624.47	129.9
B7535M10	Cyl. Mount (M/F) 75x35mm M10x30/M10	75	35	M10x30/M10	258.83	59.6	533.83	129.9
B7535M12	Cyl. Mount (M/F) 75x35mm M12x37/M12	75	35	M12x37/M12	258.83	59.6	533.83	129.9
B7540M10	Cyl. Mount (M/F) 75x40mm M10x30/M10	75	40	M10x30/M10	223.52	59.6	443.3	129.9
B7540M12	Cyl. Mount (M/F) 75x40mm M12x37/M12	75	40	M12x37/M12	223.52	59.6	443.3	129.9
B7545M10	Cyl. Mount (M/F) 75x45mm M10x30/M10	75	45	M10x30/M10	209.55	59.6	423.83	129.9
B7545M12	Cyl. Mount (M/F) 75x45mm M12x37/M12	75	45	M12x37/M12	209.55	59.6	423.83	129.9
B7550M10	Cyl. Mount (M/F) 75x50mm M10x30/M10	75	50	M10x30/M10	194.26	59.6	399.52	129.9
B7550M12	Cyl. Mount (M/F) 75x50mm M12x37/M12	75	50	M12x37/M12	194.26	59.6	399.52	129.9
B7555M10	Cyl. Mount (M/F) 75x55mm M10x30/M10	75	55	M10x30/M10	185.79	59.6	386.87	129.9
B7555M12	Cyl. Mount (M/F) 75x55mm M12x37/M12	75	55	M12x37/M12	185.79	59.6	386.87	129.9
B7560M10	Cyl. Mount (M/F) 75x60mm M10x30/M10	75	60	M10x30/M10	170.5	59.6	352	118.6
B7560M12	Cyl. Mount (M/F) 75x60mm M12x37/M12	75	60	M12x37/M12	170.5	59.6	352	118.6
B7570M10	Cyl. Mount (M/F) 75x70mm M10x30/M10	75	70	M10x30/M10	154	50.3	326.04	115.2
B7570M12	Cyl. Mount (M/F) 75x70mm M12x37/M12	75	70	M12x37/M12	154	50.3	326.04	115.2
B8030M14	Cyl. Mount (M/F) 80x30mm M14x35/M14	80	30	M14x35/M14	382.25	104.1	724.57	197
B8050M14	Cyl. Mount (M/F) 80x50mm M14x35/M14	80	50	M14x35/M14	285	104.1	597.1	197

This information is for customer guidance only. Polymax reserves the right to amend specification without prejudice.

Polymax Ltd, Building 90, SEME, Budds Lane, Bordon, Hampshire, GU35 0JE

Email: sales@polymax.co.uk Phone: +44 (0) 1420 474123 Fax: +44 (0) 1420 487816

B8060M14	Cyl. Mount (M/F) 80x60mm M14x35/M14	80	60	M14x35/M14	164	104.1	309	197
B9050MS1215	Cyl. Mount (M/F) 90x50mm M12x14/M12	90	50	M12x14/M12	383.3	99	752	198.6
B100100M12	Cyl. Mount (M/F) 100x100mm M12x33/M12	100	100	M12x33/M12	275	106	440.66	230.9
B100100M16	Cyl. Mount (M/F) 100x100mm M16x45/M12	100	100	M16x45/M12	275	106	440.66	230.9
B10040M12	Cyl. Mount (M/F) 100x40mm M12x33/M12	100	40	M12x33/M12	499.51	106	940.39	230.9
B10040M16	Cyl. Mount (M/F) 100x40mm M16x45/M16	100	40	M16x45/M16	499.51	106	940.39	230.9
B10045M12	Cyl. Mount (M/F) 100x45mm M12x33/M12	100	45	M12x33/M12	454.85	106	869	230.9
B10045M16	Cyl. Mount (M/F) 100x45mm M16x45/M12	100	45	M16x45/M12	454.85	106	869	230.9
B10050M12	Cyl. Mount (M/F) 100x50mm M12x33/M12	100	50	M12x33/M12	393.47	106	814	230.9
B10050M16	Cyl. Mount (M/F) 100x50mm M16x45/M12	100	50	M16x45/M12	393.47	106	814	230.9
B10055M12	Cyl. Mount (M/F) 100x55mm M12x33/M12	100	55	M12x33/M12	380.05	106	762.19	230.9
B10055M16	Cyl. Mount (M/F) 100x55mm M16x45/M12	100	55	M16x45/M12	380.05	106	762.19	230.9
B10060M12	Cyl. Mount (M/F) 100x60mm M12x33/M12	100	60	M12x33/M12	332.2	106	665.5	230.9
B10060M16	Cyl. Mount (M/F) 100x60mm M16x45/M12	100	60	M16x45/M12	332.2	106	665.5	230.9
B10070M12	Cyl. Mount (M/F) 100x70mm M12x33/M12	100	70	M12x33/M12	319	106	583.66	230.9
B10070M16	Cyl. Mount (M/F) 100x70mm M16x45/M12	100	70	M16x45/M12	319	106	583.66	230.9
B10075M12	Cyl. Mount (M/F) 100x75mm M12x33/M12	100	75	M12x33/M12	302.5	106	480.26	230.9
B10075M16	Cyl. Mount (M/F) 100x75mm M16x45/M12	100	75	M16x45/M12	302.5	106	480.26	230.9
B10080M12	Cyl. Mount (M/F) 100x80mm M12x33/M12	100	80	M12x33/M12	289.3	106	449.13	230.9
B10080M16	Cyl. Mount (M/F) 100x80mm M16x45/M12	100	80	M16x45/M12	289.3	106	449.13	230.9
B15050M16	Cyl. Mount (M/F) 150x50mm M16x45/M16	150	50	M16x45/M16	688.93	194.7	1290.96	355.1
B15050M20	Cyl. Mount (M/F) 150x50mm M20x45/M20	150	50	M20x45/M20	688.93	194.7	1290.96	355.1
B15055M16	Cyl. Mount (M/F) 150x55mm M16x45/M16	150	55	M16x45/M16	649.99	194.7	1184.26	355.1
B15055M20	Cyl. Mount (M/F) 150x55mm M20x45/M20	150	55	M20x45/M20	649.99	194.7	1184.26	355.1
B15060M16	Cyl. Mount (M/F) 150x60mm M16x45/M16	150	60	M16x45/M16	587.73	194.7	1050.83	355.1
B15060M20	Cyl. Mount (M/F) 150x60mm M20x45/M20	150	60	M20x45/M20	587.73	194.7	1050.83	355.1
B15075M16	Cyl. Mount (M/F) 150x75mm M16x45/M16	150	75	M16x45/M16	492.58	185.5	886.6	319.6
B15075M20	Cyl. Mount (M/F) 150x75mm M20x45/M20	150	75	M20x45/M20	492.58	185.5	886.6	319.6
B200100M20	Cyl. Mount (M/F) 200x100mm M20x41/M20	200	100	M20x41/M20	1320	396	2200	660

This information is for customer guidance only. Polymax reserves the right to amend specification without prejudice.

Polymax Ltd, Building 90, SEME, Budds Lane, Bordon, Hampshire, GU35 0JE

Email: sales@polymax.co.uk Phone: +44 (0) 1420 474123 Fax: +44 (0) 1420 487816